

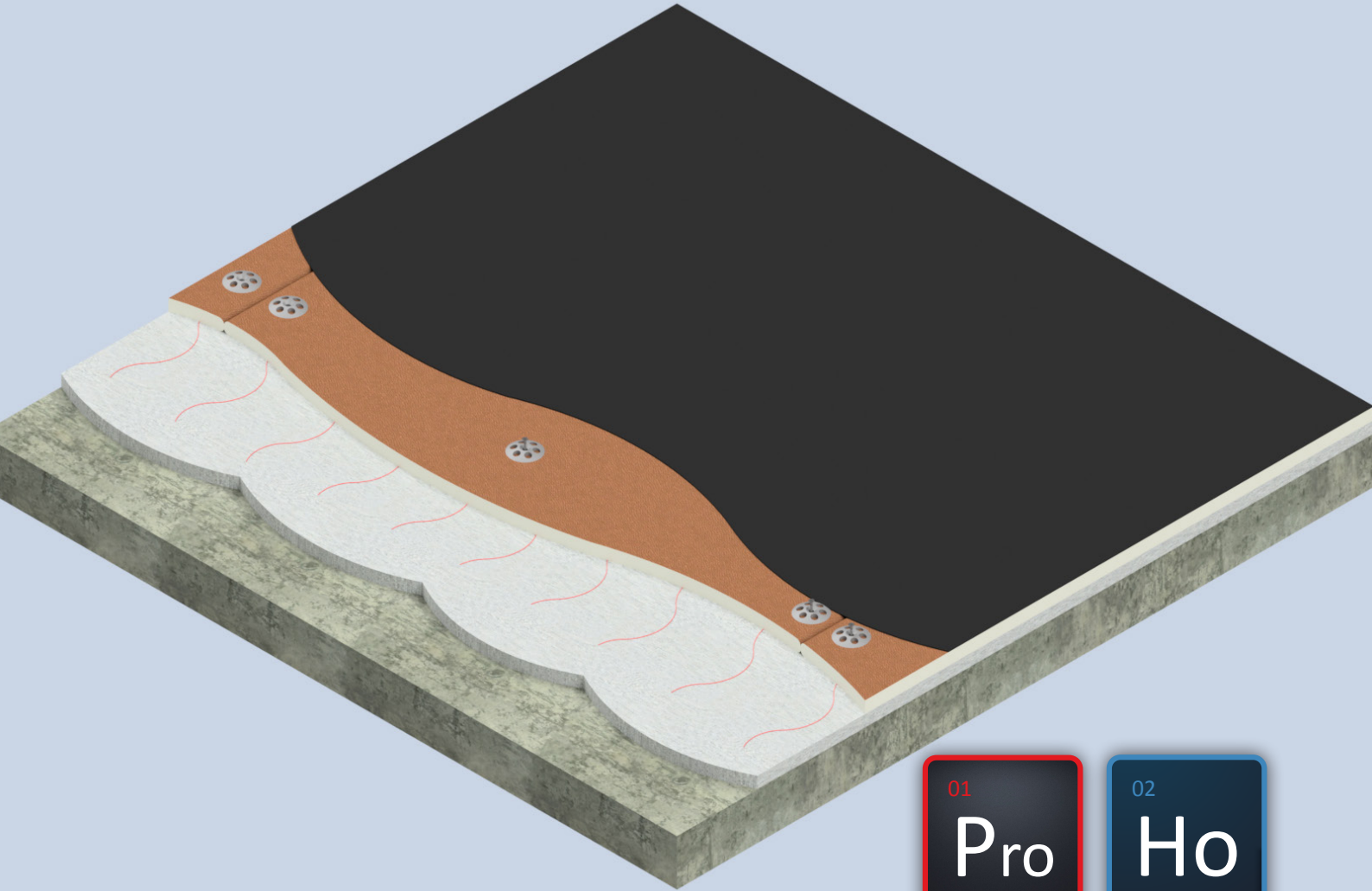

LAMBDABOARD[®]
THE BETTER THERMAL INSULATION



01

Pro

Professional's
Choice

02

Ho

Home Owner's
Choice

LAMBDABOARD[®]

SLAB INSULATION WITH WATERPROOF MEMBRANE

LAMBDABOARD[®] is the ideal choice for under purlin insulation in all building categories especially in retrofits. It is manufactured in a continuous process with a closed cell PIR core bonded to 2 flexible substrates.

LAMBDABOARD[®] with a bitumised kraft finish or white mineral, is a cost-effective insulation option for flat roofs. LAMBDABOARD[®] does not reduce the floor-to-soffit height and improves the thermal performance of the building. This product is SANS 10400 XA & 204 compliant.



SLAB INSULATION - WITH WATERPROOF MEMBRANE

BENEFITS

Waterproofing systems can be applied directly onto LAMBDABOARD®, thus reducing labour and material costs

Thermoset material is dimensionally stable

Moisture resistance

Superior long term R-Value

High compressive strength

INSTALLATION

LAMBDABOARD® must be laid on top of screed to fall, boards to be secured with either mechanical fixings or adhesives. With waterproofing membrane over LAMBDABOARD®.

SPECIFICATION FOR BOQ







LAMBDABOARD® is a laminated polyisocyanurate core board with a minimum core density of 34kg/m³, a minimum thickness of ____ mm; faced with ____ and laminated on both sides. Suppliers fixing details supplied in widths of 1220 mm with a ____ (Km²/W) R-Value. Finish shall be white mineral and mineral natural or bitumised kraft laminated on each side. LAMBDABOARD® to be installed using nylon anchors fixed through the board into concrete in accordance with manufacturers specification. Waterproofing membrane to be applied in accordance with relevant manufacturers details.

► APPLICATION: LOOSE LAY

Waterproofing membrane to be applied in accordance with relevant manufacturers details.

► APPLICATION: SPRAY APPLIED ULTRASEAL POLYURETHANE

Ultraseal Polyurethane Waterproofing system to be applied in accordance with relevant manufacturers details to a minimum thickness of 1.5 mm.

<p>LONG TERM THERMAL RESISTANCE</p>  <p><</p>	<p>LABOUR SAVING</p> <p>75%</p>  <p><</p>	<p>TEMPERATURE RANGE</p>  <p>-30° C to 120° C</p> <p><</p>	<p>HIGH COMPRESSIVE STRENGTH</p>  <p><</p>	<p>ENERGY SAVING</p> <p></70%</p> <p>With a rational design</p> <p><</p>	<p>LOW MAINTENANCE</p>  <p>Thickness: 25 mm to 100 mm</p> <p>Width: 1220 mm</p> <p>Length: Cut to size Minimum: 1350 mm</p> <p><</p>	<p>MOISTURE RESISTANCE</p>  <p>On cavity wall and under screed installations</p> <p><</p>
--	--	---	---	---	---	--

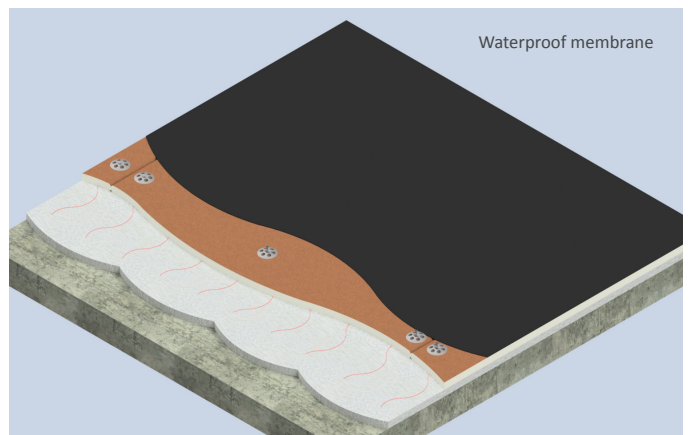

www.lambdaboard.co.za
lambdaboard@rigifoam.com
+27 (0)11 421 0313

Members of:



Proudly produced by:



DISAVOWAL: The customer acknowledges and understands that after delivery, the goods will have left the control of Rigifoam (Pty) Ltd, and that the customer will be responsible for the unpacking of and connection/installation of the goods. The customer acknowledges that it is his/her further responsibility to ensure that a fully qualified and competent person is used to install the goods to ensure their effective operation. Failure by the customer to ensure the installation of the goods, according to the written instructions of the manufacturer and/or supplier, by a fully qualified and competent person, may result in the failure of the goods, injury, loss or damages to the customer. Accordingly, and in this event, Rigifoam (Pty) Ltd accepts no responsibility for any loss or damages that might arise by reason of death or personal injury to any person engaged in the installation or use of the goods thereafter, subject to the provisions of the Consumer Protection Act 68 of 2008.